

# Kit 1271

**MAZDA Demio**, 5-dr MPV, 02-07 (JPN)\*

**MAZDA 2**, 5-dr MPV, 03-07\*

\* Without roof spoiler

480R  
754

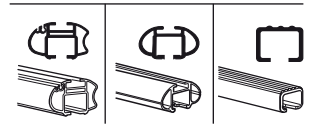
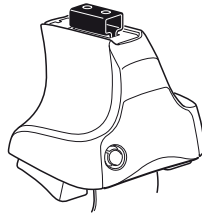

480

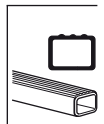
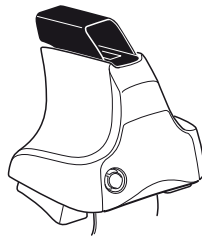

750

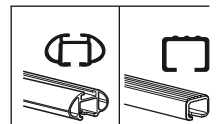
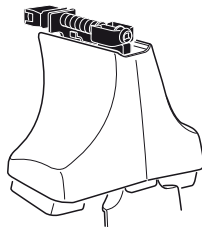

**Kit**



3

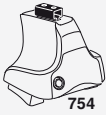

754

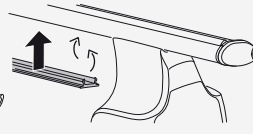
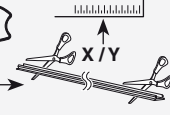

750

1

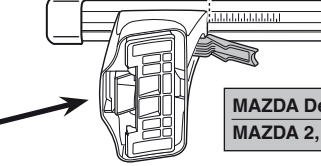

2

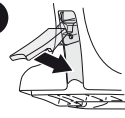

X	
MAZDA Demio, 5-dr MPV, 02-07 (JPN)	26
MAZDA 2, 5-dr MPV, 03-07	26

X

1

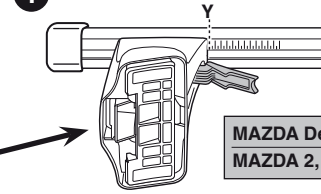

2

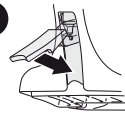

Y	
MAZDA Demio, 5-dr MPV, 02-07 (JPN)	25
MAZDA 2, 5-dr MPV, 03-07	25

Y



480R



480

1

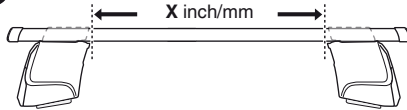

2



X inch	X mm
MAZDA Demio, 5-dr MPV, 02-07 (JPN)	35 7/8" 911 mm
MAZDA 2, 5-dr MPV, 03-07	35 7/8" 911 mm

X inch

X mm

1

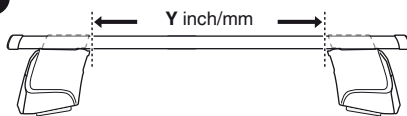

2

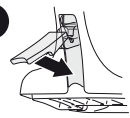

Y inch	Y mm
MAZDA Demio, 5-dr MPV, 02-07 (JPN)	35 1/2" 901 mm
MAZDA 2, 5-dr MPV, 03-07	35 1/2" 901 mm

Y inch

Y mm

# 4

MAZDA Demio, 5-dr MPV, 02-07 (JPN)

MAZDA 2, 5-dr MPV, 03-07

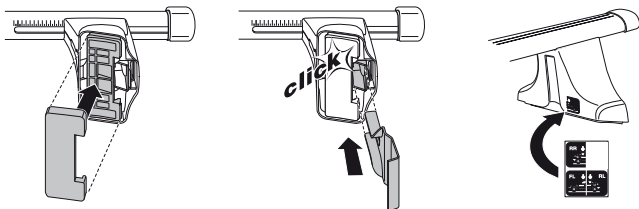
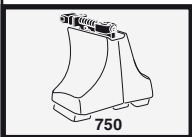
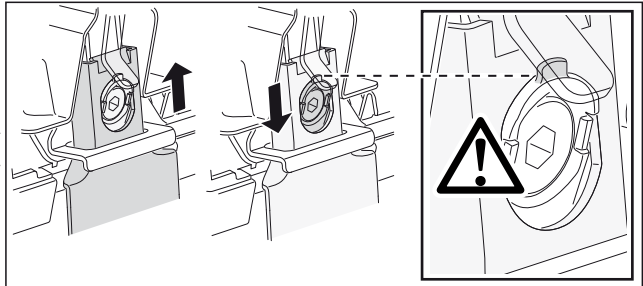
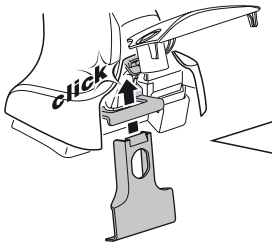
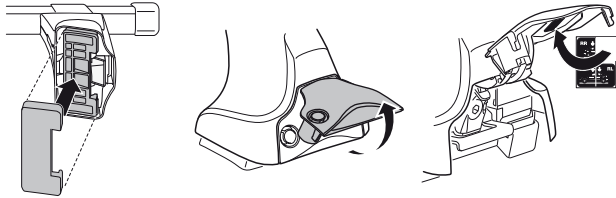
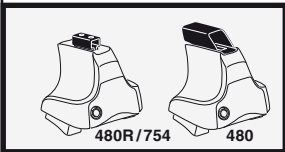
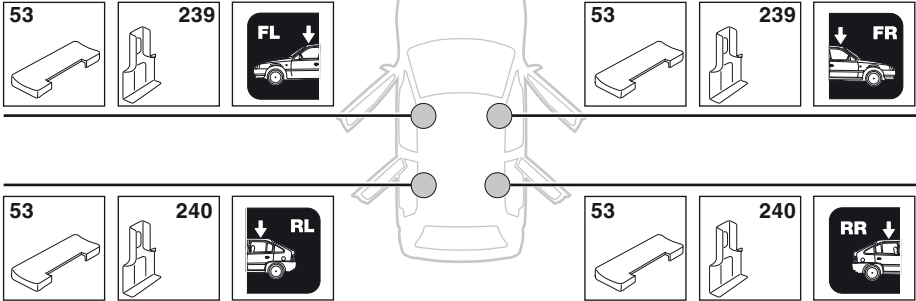

5



	X mm	Y mm	X inch	Y inch
MAZDA Demio, 5-dr MPV, 02-07 (JPN)	420 mm	710 mm	16 1/2"	28"
MAZDA 2, 5-dr MPV, 03-07	420 mm	710 mm	16 1/2"	28"

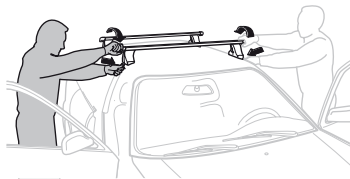
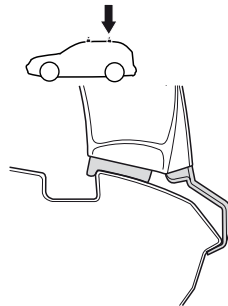
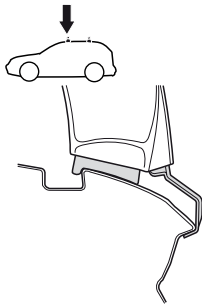
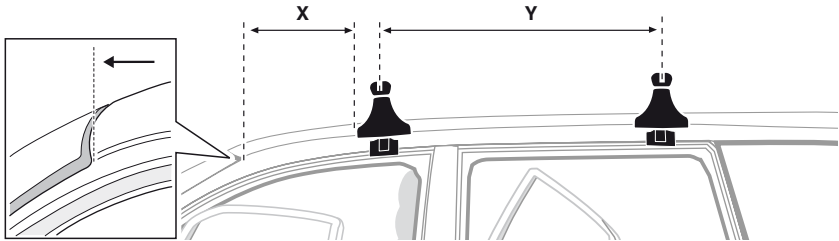

**GB/US** Tighten alternately

**D** Die Schrauben abwechselnd anziehen

**F** Serrer alternativement chaque côté

**NL** Afwisselend aan de linker- en de rechterkant aandraaien

**I** Alternare il serraggio delle viti

**E** Apretar alternativamente

**PT** Aperte alternadamente

**S** Dra åt växelvis

**FIN** Kierrä vuorotellen

**EST** Pinguldage vaheldumisi

**LAT** Pielieciet pamišus

**LIT** Užsukinėkite pakaitomis

**PL** Śruby dokręcaj naprzemiennie

**RU** Затягивайте попеременно

**CZ** Pokręťta bagażníka dokręcaj dokręcaj naprzemiennie.

**SK** Doťahujte striedavo

**SLO** Privijajte izmenično.

**HR** Naizmjenično zategnite

**HU** Egymástól függetlenül szorítandó

**GR** Σφιγγετε εναλλάξ

**TR** Dönüşümlü sıkın

**中文** 交替拧紧

**한국어** 번갈아 가며 조이십시오.

**日本語** 交互に締め付けてください。

**ไทย** ชั้สลับแบบสลับ

6



480R/754



480

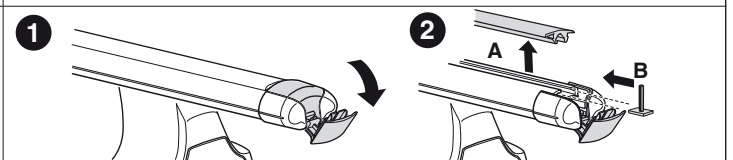
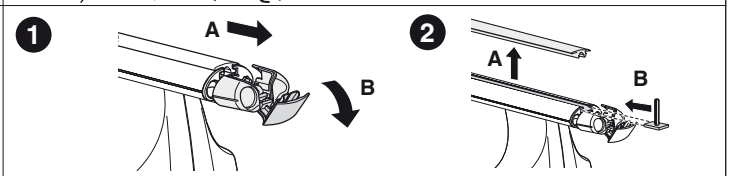
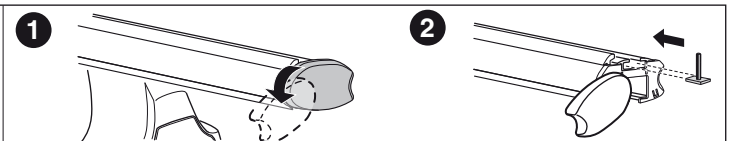
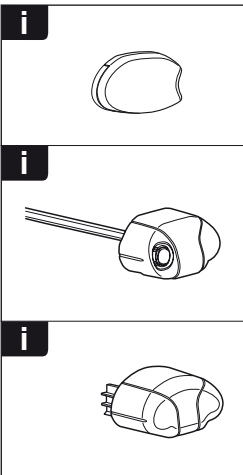
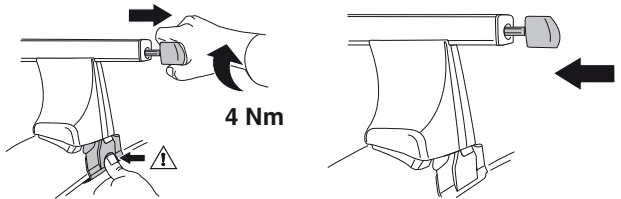
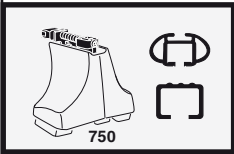



**THULE**  
SWEDEN  
**ONE  
KEY  
SYSTEM**



- 544 (x4)
- 596 (x6)
- 588 (x8)
- NA 510 (x10)
- EUR 452 (x12)
- ASIA



WW ▶ Thule Sweden AB, Box 69, 330 33 Hillerstorp, SWEDEN  
NA ▶ Thule Inc., 42 Silvermine Road, Seymour, Connecticut 06483, USA

info@thule.com  
customer.service@thule.com

www.thule.com